

S/R

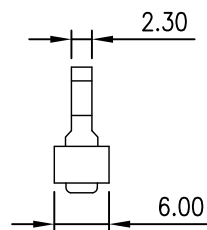
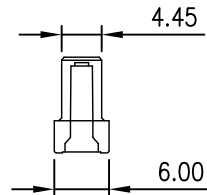
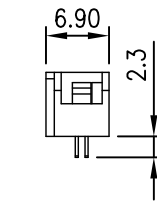

Circuits	Dimension mm		
	A	B	C
2X3	12.30	5.08	6.35
2X4	14.84	7.62	8.89
2X5	17.38	10.16	11.43
2X6	19.92	12.70	13.97
2X7	22.46	15.24	16.51
2X8	25.00	17.78	19.05
2X9	27.54	20.32	21.59
2X10	30.08	22.86	24.13
2X12	35.16	27.94	29.21
2X13	37.70	30.48	31.75
2X15	42.78	35.56	36.83
2X16	45.32	38.10	39.37
2X17	47.86	40.64	41.91
2X18	50.40	43.18	44.45
2X20	55.48	48.26	49.53
2X22	60.56	53.34	54.61
2X24	65.64	58.42	59.69
2X25	68.18	60.96	62.23
2X30	80.88	73.66	74.93
2X32	85.96	78.74	80.01

REV	DESCRIPTION	DATE
A1	EN991213-1	2010.12.13

NOTES

Available in 06 through 64 Circuits
 Material: PBT UL94-V0
 Contact Material: Phosphor bronze or Brass
 Contact Plated: Gold over nickel
 Wire Size Flat Cable I.D.C: 1.27mm Pitch
 AWG #28 (Standard 0.20mm) or #30 (0.17mm)

SPECIFICATION

Current Rating: 1A
 Contact Resistance: 30mΩ Max. at 6V DC 0.3A
 Insulation Resistance: 1000MΩ/Min. at 500V DC
 Dielectric Withstanding Voltage: 500V AC/minute
 Operation Temperature: -40°C to +105°C

ORDERING INFORMATION

YY-4600 - ** H * * *
1 2 3 4 5

- No. of Circuits 06~64
- Plated
H : Selective Plating
- Material
 : Brass
P : Phosphor Bronze
- A : Two without S/R
B : Three with S/R
- : W/O Lock
W : W/Lock

TOLERANCE	
X.	--
X.X	±0.35
X.XX	±0.25
X.XXX	±0.10
ANGULAR	--



Young Yak Enterprise Co., Ltd.

TITLE
2.54mm(.100") Pitch IDC Socket

APPROVALS		VIEW	SCALE	PART NO.	REV.
DRAWN	Kang		F	YY-4600-**H***	A2
CHECKED	Denise				
APPROVED	Jessica	UNIT	SIZE	DWG NO.	SHEET
		MM	A4	YY-4600-**H***-143	1 OF 1